

Part number

CHI 10 C



Bulkhead mounting housing, C-TYPE series,
with 4 pegs, size "57.27"



Product description

Product type	Bulkhead mounting housing
Series	C-TYPE
Closing type	with 4 pegs
Size	size "57.27"

Technical data

IP degree of protection	IP66 (and IP69 DIN 40050 - 9)
--------------------------------	-------------------------------

Further technical details

Weight	67,00 g
Operating temperature range (min, max)	-40 °C...+125 °C

Approvals / Standards

Certifications	DNV-GL, BV
-----------------------	------------

General ordering information

EAN13 code	8015747017428
-------------------	---------------

Packaging Information

Sub-packaging weight	0,34 kg
Sub-packaging description	Plastic packaging
Sub-packaging quantity	5 Pcs
Sub-packaging EAN barcode	8015747017435

Part number

CHI 10 C



Catalogue drawings

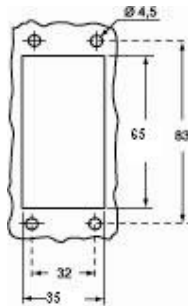

Catalogue drawings

CHI

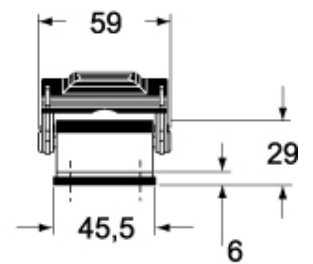
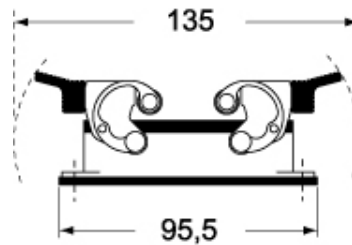

CHI C

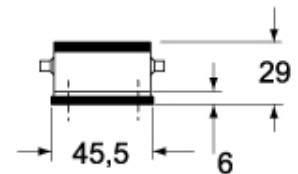
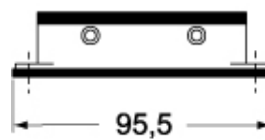

CHI CS/CP

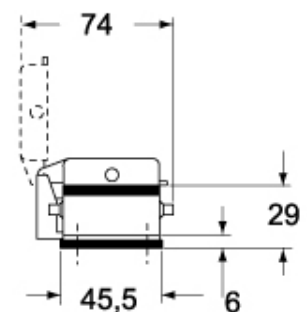
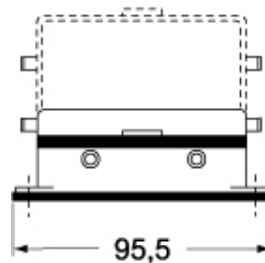

Notes

Dimensions shown in mm are not binding and may be changed without notice.